

# Ocel kruhová za tepla válcovaná

Round bars

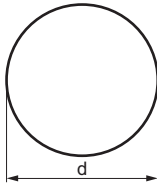

EN 10060

TDP: EN 10025-2

Značka oceli: **S235 JR+AR**  
**S355 JR+AR**

HUTNÍ MATERIÁL

| Jmenovitý průměr d | Hmotnost [kg/m] | Průřez [mm²] | Mezní úchylna přesnosti |
|--------------------|-----------------|--------------|-------------------------|
| 5,5                | 0,187           | 23,800       | ±0,4 mm                 |
| 6,0                | 0,222           | 28,274       |                         |
| 8,0                | 0,395           | 50,265       |                         |
| 10                 | 0,617           | 78,540       |                         |
| 12                 | 0,888           | 113,10       |                         |
| 14                 | 1,208           | 153,94       |                         |
| 15                 | 1,387           | 176,71       | ±0,5 mm                 |
| 16                 | 1,578           | 201,06       |                         |
| 18                 | 1,998           | 254,47       |                         |
| 20                 | 2,466           | 314,16       |                         |
| 22                 | 2,984           | 380,13       |                         |
| 24                 | 3,551           | 452,39       |                         |
| 25                 | 3,853           | 490,87       | ±0,6 mm                 |
| 28                 | 4,834           | 615,75       |                         |
| 30                 | 5,549           | 706,86       |                         |
| 32                 | 6,313           | 804,25       |                         |
| 35                 | 7,553           | 962,11       | ±0,8 mm                 |
| 38                 | 8,903           | 1134,1       |                         |
| 40                 | 9,865           | 1256,6       |                         |
| 42                 | 10,876          | 1385,4       |                         |
| 45                 | 12,485          | 1590,4       |                         |
| 48                 | 14,205          | 1809,6       |                         |
| 50                 | 15,413          | 1963,5       | ±1,0 mm                 |
| 55                 | 18,650          | 2375,8       |                         |
| 60                 | 22,195          | 2827,4       |                         |
| 65                 | 26,049          | 3318,3       |                         |
| 70                 | 30,210          | 3848,5       |                         |
| 75                 | 34,680          | 4417,9       |                         |
| 80                 | 39,458          | 5026,5       | ±1,3 mm                 |
| 85                 | 44,545          | 5674,5       |                         |
| 90                 | 49,940          | 6361,7       |                         |
| 95                 | 55,643          | 7088,20      |                         |
| 100                | 61,654          | 7854,00      |                         |

| Jmenovitý průměr d | Hmotnost [kg/m] | Průřez [mm²] | Mezní úchylna přesnosti |
|--------------------|-----------------|--------------|-------------------------|
| 105                | 6,28            | 8659,0       | ±1,5 mm                 |
| 110                | 6,68            | 9503,3       |                         |
| 115                | 7,07            | 10387,0      |                         |
| 120                | 7,85            | 11310,0      |                         |
| 125                | 8,64            | 12272,0      | ±2,0 mm                 |
| 130                | 9,42            | 13273,0      |                         |
| 135                | 9,81            | 14314,0      |                         |
| 140                | 10,21           | 15394,0      |                         |
| 145                | 10,99           | 16513,0      |                         |
| 150                | 11,78           | 17671,0      |                         |
| 155                | 12,95           | 18869,0      | ±2,5 mm                 |
| 160                | 13,74           | 20106,0      |                         |
| 165                | 15,70           | 21382,0      |                         |
| 170                | 17,66           | 22698,0      |                         |
| 175                | 19,63           | 24053,0      |                         |
| 180                | 21,59           | 25447,0      |                         |
| 185                | 23,55           | 26880,0      | ±1,5 % d                |
| 190                | 27,48           | 28353,0      |                         |
| 195                | 31,40           | 29884,0      |                         |
| 200                | 6,28            | 31416,0      |                         |
| 205                | 6,68            | 33010,0      |                         |
| 210                | 7,07            | 34600,0      |                         |
| 220                | 7,85            | 38000,0      | ±1,5 % d                |
| 225                | 8,64            | 39755,0      |                         |
| 230                | 9,42            | 41548,0      |                         |
| 235                | 9,81            | 43395,0      |                         |
| 240                | 10,21           | 45239,0      |                         |
| 245                | 10,99           | 47165,0      |                         |
| 250                | 11,78           | 49087,0      |                         |
| 260                | 12,95           | 53093,0      |                         |
| 270                | 13,74           | 57265,0      |                         |
| 280                | 15,70           | 61575,0      |                         |
| 300                | 17,66           | 70686,0      |                         |